

RoHS
Compliant

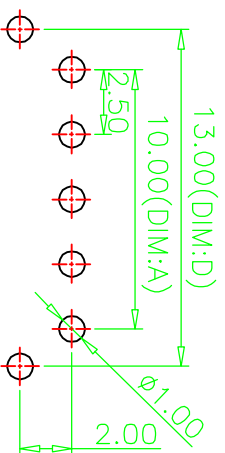
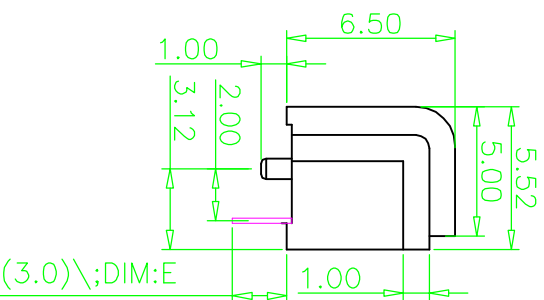
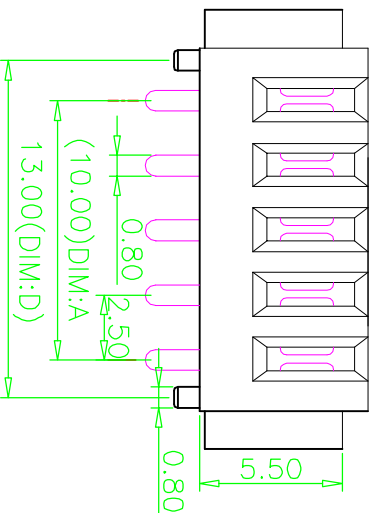
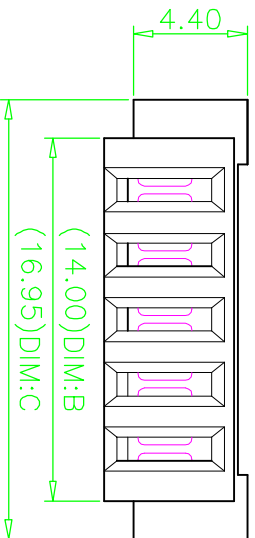

Recommended P.C.B Layout

Layout Tolerance= +/- 0.05mm

结构图面

REV	DESCRIPTION	APPR	CHECK	DRAW	DATE
1	原始图档		JACK		120606

Material
Insulator:Nylon 9T(UL94V-0)
Contact:phosphor Bronze
Contact Plated:Gold over Nickel or Tin
Specification
Current rating:7A
Instant CURRENT:10A
Contact Resistance:30MΩ
Insulation Resistance:100MΩ
Dielectric Voltage:500V
Operating Temperature:-40°~105°

No:of pins	Dimension				
	DIM.A	DIM.B	DIM.C	DIM.D	DIM.E
03	5.00	9.00	11.95	8.00	2.1/3.0
04	7.50	11.50	14.45	10.50	2.1/3.0
05	10.00	14.00	16.95	13.00	2.1/3.0
06	12.50	16.50	19.45	15.50	2.1/3.0
07	15.00	19.00	21.96	18.00	2.1/3.0
08	17.50	21.50	24.45	20.50	2.1/3.0
09	20.00	24.00	26.95	23.00	2.1/3.0
10	22.50	26.50	29.45	25.50	2.1/3.0
11	25.00	29.00	31.95	28.00	2.1/3.0

QUALITY SYMBOLS	GENERAL TOLERANCES (UNLESS SPECIFIED)		SCALE: 1:1	NUMBER:	TITLE:	
	MM	INCH			Battery P12.5mm 母座 插板式	
∇_{-0}	± 0.25	$\frac{1}{16}$			DESIGNED BY:	THIRD ANGLE PROJECTION
∇_{-0}	± 0.15	$\frac{1}{32}$			DRAWN BY:	REVISE ON CAD ONLY
	± 0.05	$\frac{1}{64}$			CHECKED BY:	DWG NO.:
	ANGULAR $\pm 1^\circ$				APPROVED BY:	SHEET NO. 1/1
DRAFT WHERE APPLICABLE MUST REMAIN WITHIN DIMENSIONS						
无锡联庭电子科技有限公司						